

6"-150# R.F.S.O.  
 FLG. W/SCH 80  
 SA-106-B  
 PIPE x 7 5/8"LG.  
 (2) PLC'S

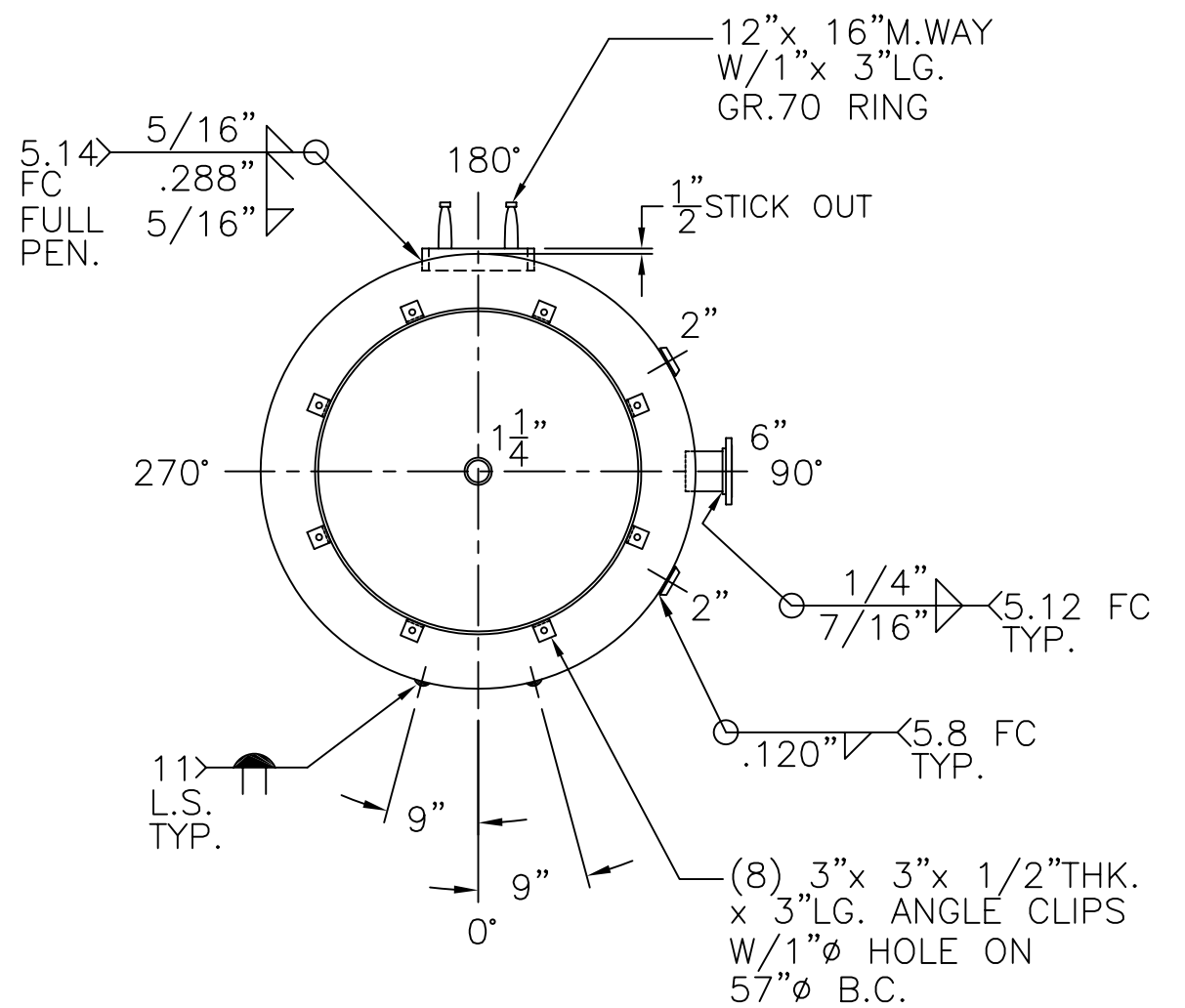
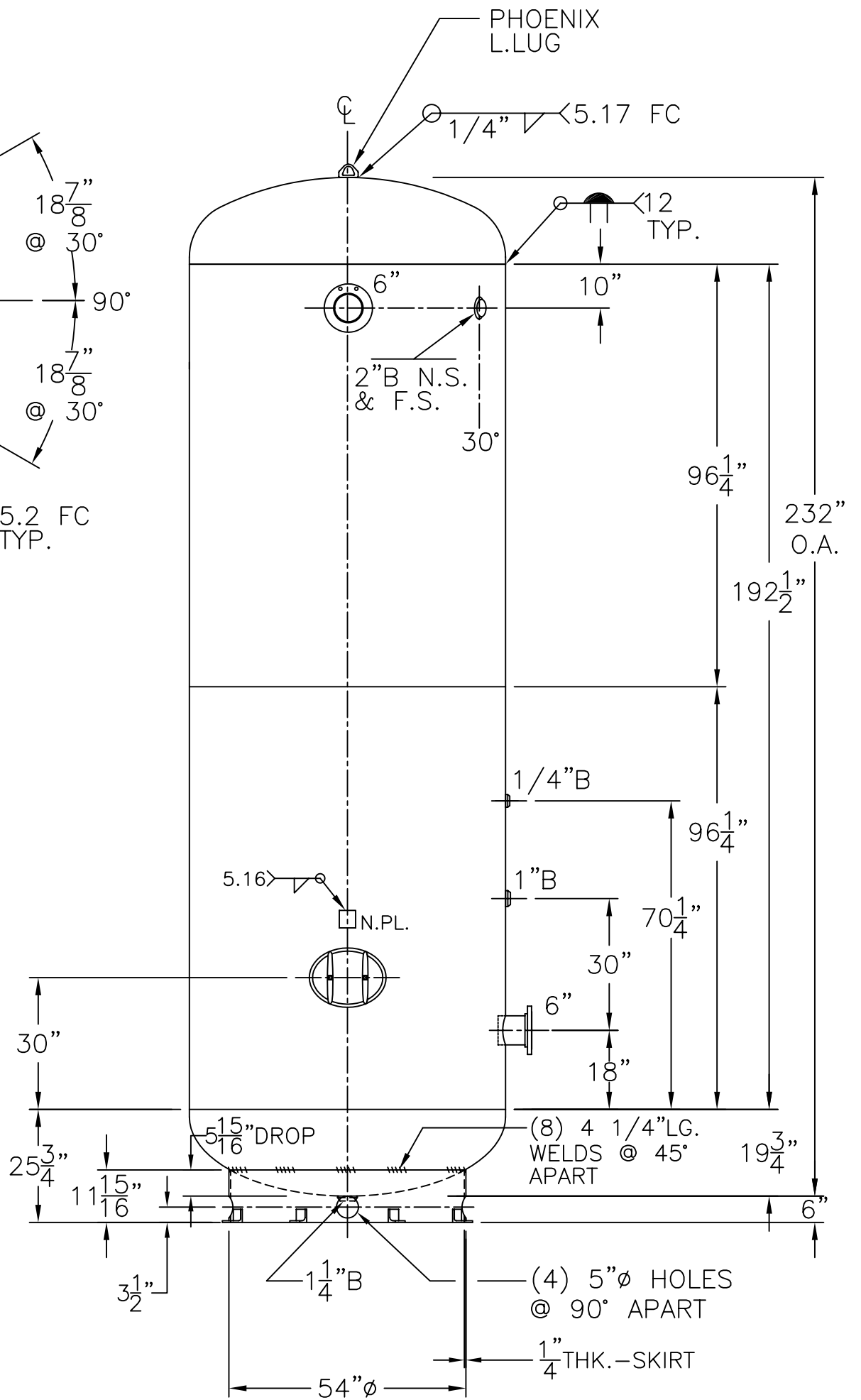

NOTE: 1) HYDRO @ 179 PSIG. MIN.

|   |                    |                                       |      |
|---|--------------------|---------------------------------------|------|
| SHELL / HEADS                           |                    | .280" SA-455 2:1 S.E.<br>(.234" MIN.) |      |
| .288" SA-455                            |                    |                                       |      |
| M.A.W.P.                                | 137 PSIG. @ 400 °F |                                       |      |
| M.D.M.T.                                | -20 °F 137 PSIG    |                                       |      |
| ASME SECTION VIII DIV. 1, 2010 ADD 2010 |                    |                                       |      |
| X-RAY: RT-4 SPOT L.S. & HDS. G.S.       |                    |                                       |      |
| GALLONS:                                | 3800               | WT. 5102                              | LBS. |
| SERIAL NO.                              |                    |                                       |      |
| N.B.                                    |                    |                                       |      |
| INSIDE: UNPAINTED                       |                    | 72-VQ-3800-R                          |      |
| OUTSIDE: PRIME                          |                    | REV. 8-15-11                          |      |
| CAD "B"-SIZE UNDER "STD"-SERIES         |                    | DATE: 8-12-99                         |      |
| BY: J.G.                                |                    | FOR: HANSON STANDARD                  |      |
| SCALE: 3/8"=12"                         |                    | VERT. AIR TANK                        |      |
| ROY E. HANSON JR. MFG.                  |                    | UW-21(b)                              |      |
| 1600 E. WASHINGTON BLVD.                |                    | INSIDE: UNPAINTED                     |      |
| LOS ANGELES, CA 90021                   |                    |                                       |      |